

Pacific Parks Estate Master Plan

- Located in Sarina, 30 minutes south of Mackay CBD
- Master-planned residential development, covering over 38 hectares of land
- Architecturally designed inter-connecting parklands incorporating open spaces, shared walk & bike paths
- Future community facilities
- Proposed Child Care Centre on site
- Wide range of allotment sizes (602m² - 3638m²) and housing styles
- Choose from land, house and land or townhouse/unit and land options

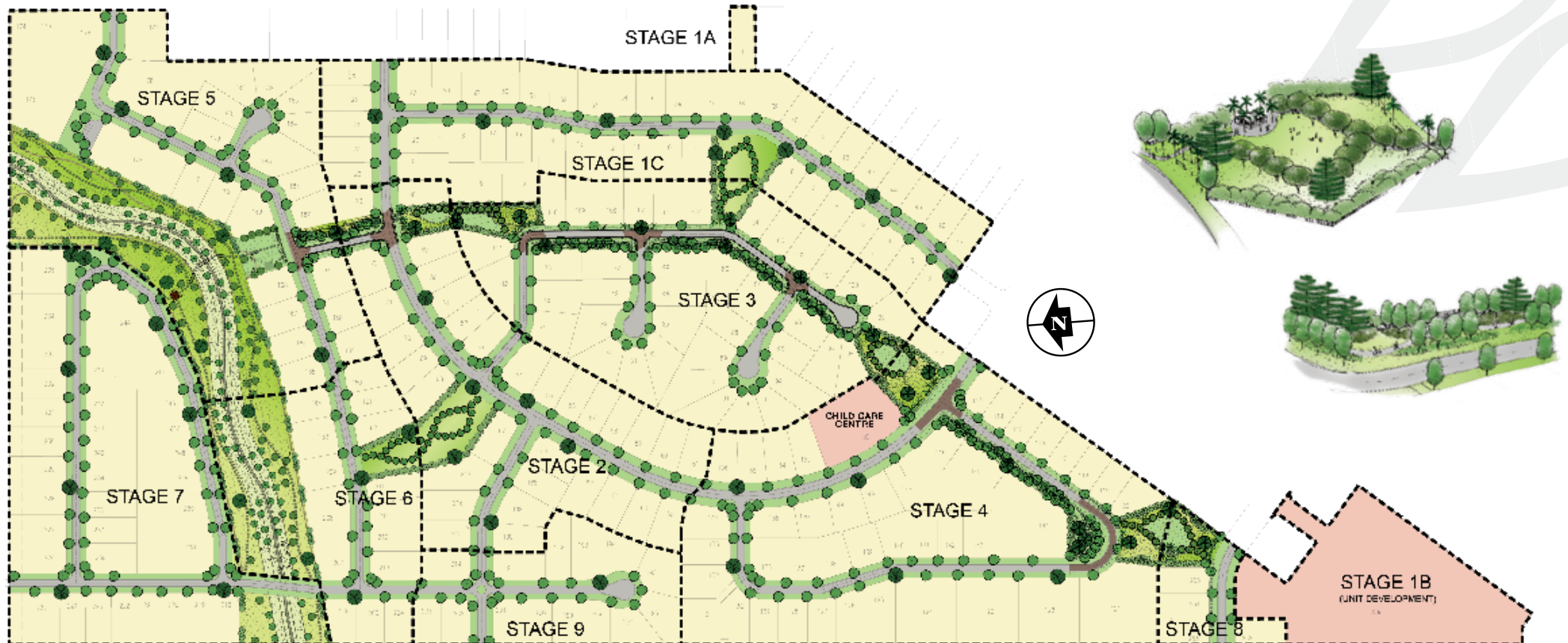

DISCLAIMER: ALL DIMENSIONS AND AREAS ARE SUBJECT TO CHANGE FROM LOCAL AUTHORITY AND FURTHER DETAILED PLANNING.